

# Zoominescence

AT THE EDMONTON VALLEY ZOO

presented by **The King's University**

## Call to Artists: Location Options

We invite you to include preferences as to where you would like your art installation to be displayed, but keep in mind that the Valley Zoo Development Society will make the final decision on artist locations.

To give yourself and your artwork the best chance of being selected, we recommend creating a piece that can be displayed in multiple locations. The following locations are presented as potential options:

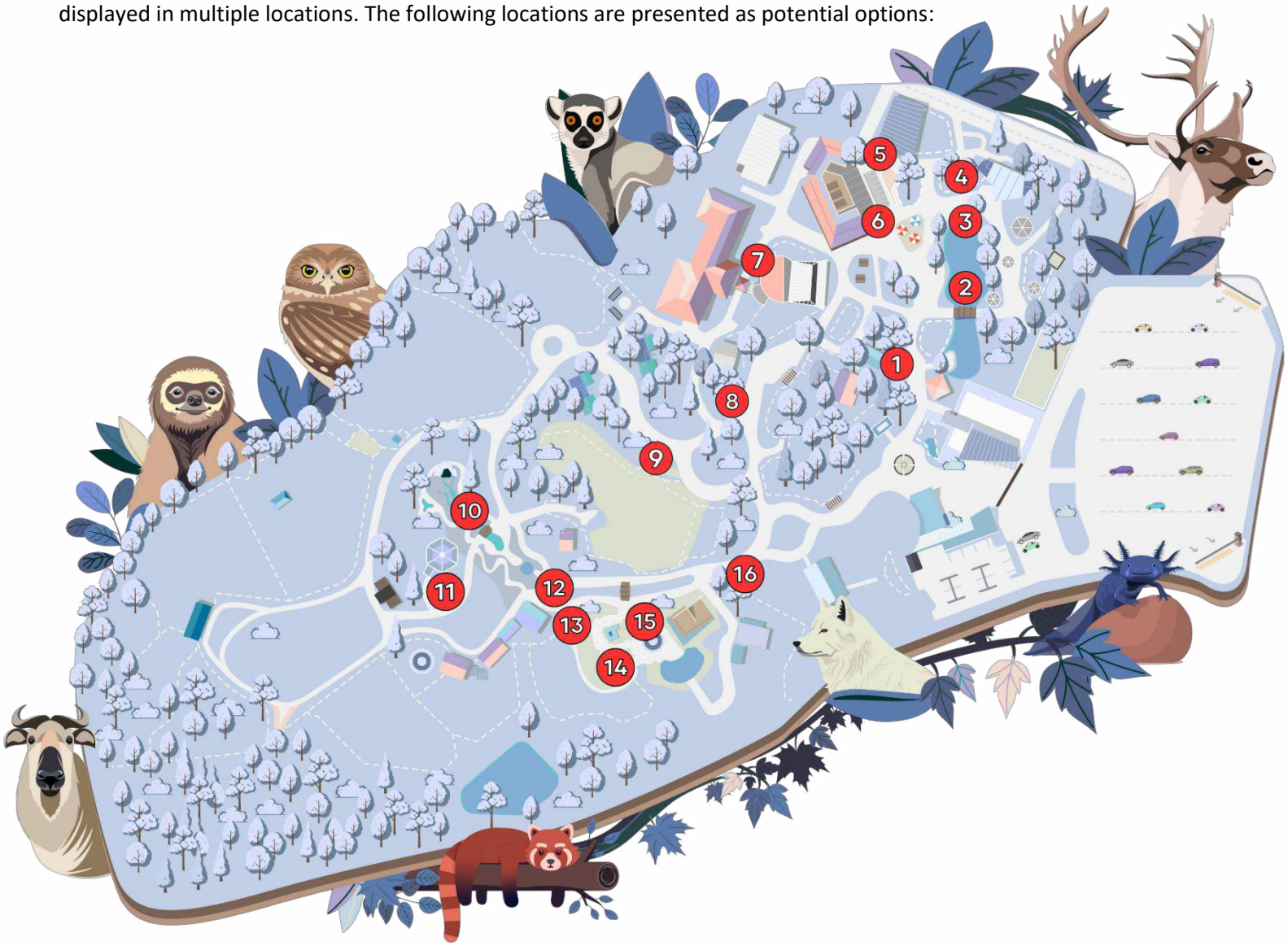

**1. Outdoor Meerkat Habitat**



**2. North Pond**



**3. North Pond Corner across Makira Island**



**4. Makira Island**



**5. Red Panda Patio**



**6. Urban Farm Tree Well**



**7. Outside Saito Centre Pedway Entrance**



**8. Corner Garden**



**9. Zebra Canopy**



**10. Meltwater Play Boulders**



**11. In Front of the Conservation Carousel**



**12. Manmade Wetland**



**13. Manmade Wetland Bench Area**



**14. Arctic Shores Artifact Area or Back Field**



**15. Empty Arctic Shores Exhibit**



**16. Hill Area beside Geodome Area**





### **Want to explore other location options?**

More locations are available depending on the needs of your artwork, so please feel free to submit your art even if there is no particular location listed that speaks to you!

Please indicate if there are any specific considerations for your art piece that we should be mindful of.

For example:

- Flat pavement or uneven ground terrain
- Guest interaction and touching allowed or no interaction or touching at all
- Better viewed close up or at a distance
- Or anything else specific to your piece you need us to know

### **Ready to bring your artistic vision to the zoo?**

We appreciate your interest in helping add your personal touch to Zoominescence this year with a beautiful work of art at the Edmonton Valley Zoo!

Please email [events@buildingourzoo.com](mailto:events@buildingourzoo.com) if you have any questions.

**Thank you, and we look forward to seeing your submission(s)!**